

JBC

www.jbctools.com

Product
website



INSTRUCTION MANUAL



MVE

Pneumatic Desoldering Module
for DDE and DME

This manual corresponds to the following reference:

MVE-A

Packing List

The following items are included:



Pneumatic Desoldering Module1 unit



Module Cable Connector1 unit
Ref. 0024228



Suction Filter1 unit
Ref. MS20



Paper Filters1 unit
Ref. MS40
Ref. contains 50 filters



Cotton Filter Set 1 unit
Ref. MS30
Ref. contains 10 filters



Exhaust Filter Kit 1 unit
Ref. MV010



Manual 1 unit
Ref. 0027991

Features and Connections

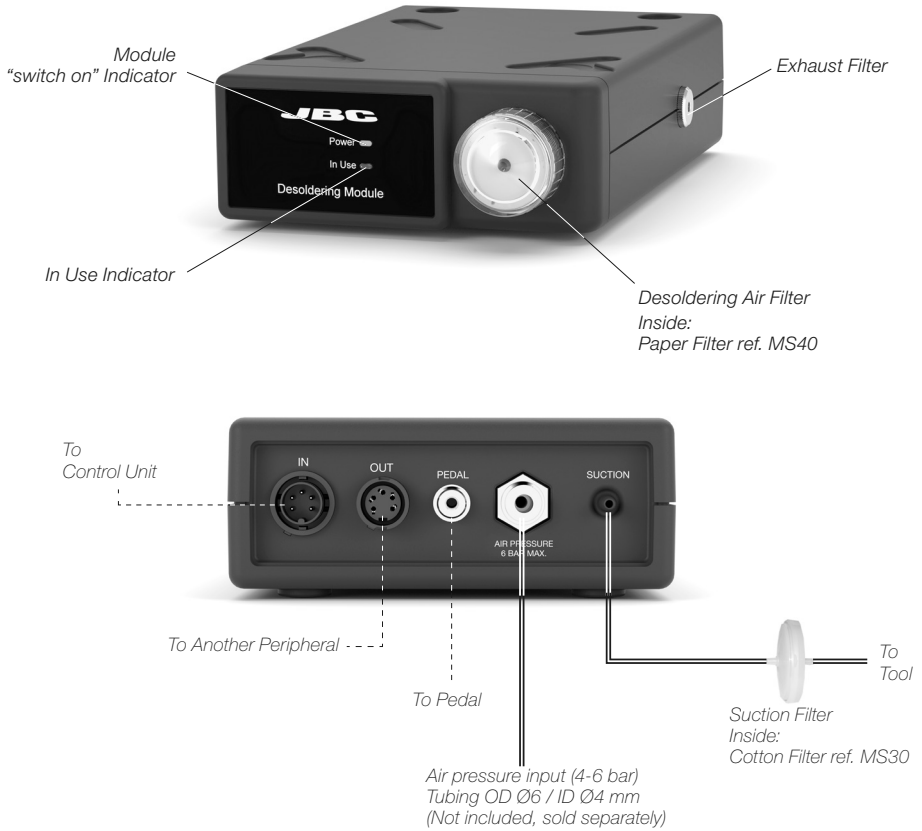

Compatibility

Select the equipment that best suit your soldering or desoldering needs.

Module	Stand	Tool	Tip Range	Control Units		Peripherals
				DDE	DME	P405
MVE	DSS	DS360	C360	●	●	●
	DRS	DR560	C560	●	●	●

Initial Set up



After connecting the module, enter the **Peripherals** menu and select the port which you want to join with the module.

Peripherals

For DDE Control Unit

1. Select the module from the list of peripheral connections. Remember your first connection is denoted as "a", the second being "b", etc. (e.g. MVE_a, MVE_b,...)
2. Press Menu or Back to save changes. Once set up, you can change the module settings by entering the **Peripherals** Menu.

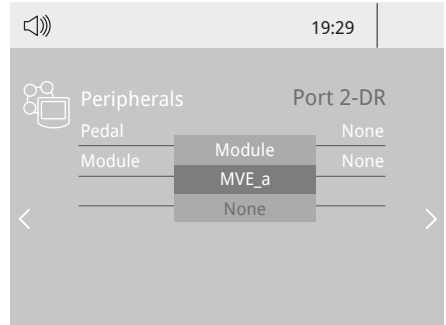

For DME Control Unit

When a new module is detected, a pop-up screen appears.

1. To configure your Electric Suction Module press Setup in the pop up window.
2. Select the module from the list of peripheral connections. Remember your first connection is denoted as "a", the second being "b", etc. (e.g. MS_a, MS_b,...). Do the same with the pedal (e.g. PD_a,...)
3. Select the port of the tool you want to link to the peripheral.
4. Press Menu or Back to save changes. Once set up, you can change the module settings by entering the **Peripherals** menu.

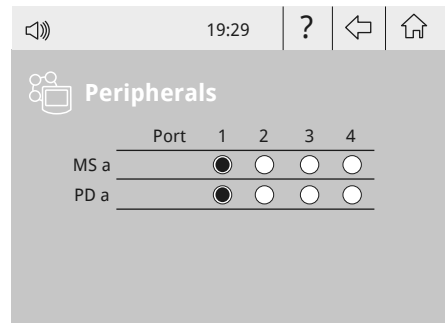
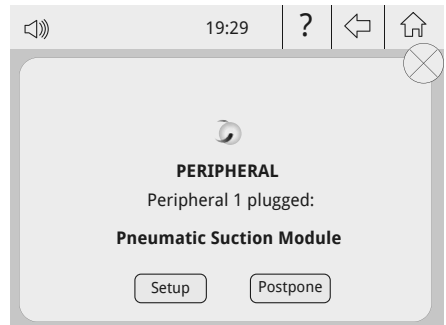

Maintenance

Before carrying out maintenance, always unplug the electric and pneumatic connectors.

- Use a damp cloth to keep the casing clean.
- Periodically check all cable and tube connections.
- Keep filters clean to ensure proper solder suction and replace them when necessary.

Important: Do not use sharp pointed objects to open the suction filter.

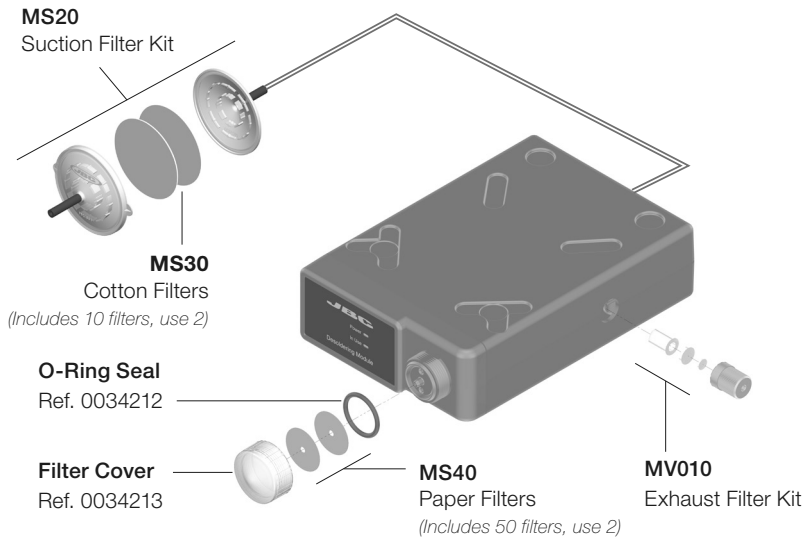

- Use original JBC spare parts on
- Do not work with defective or damaged pieces.
- Repairs should only be performed by a JBC authorized technical service.
- Maintenance must not be carried out by children unless supervised.

Removing Pneumatic Tubing

Push the release ring (1) to remove the pneumatic tubing (2).

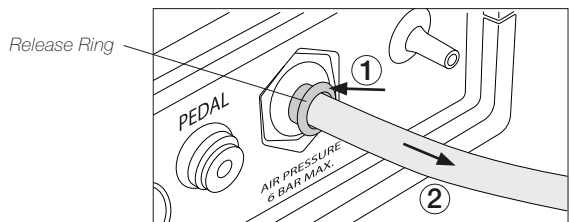

Safety



It is imperative to follow safety guidelines to prevent electric shock, injury, fire or explosion.

- Do not use the units for any purpose other than soldering or rework. Incorrect use may cause a fire.
- The power cord must be plugged into approved bases. Be sure that it is properly grounded before use. When unplugging it, hold the plug, not the wire.
- Do not work on electrically live parts.
- The tool should be placed in the stand when not in use in order to activate the sleep mode. The soldering tip or nozzle, the metal part of the tool and the stand may still be hot even when the station is turned off. Handle with care, including when adjusting the stand position.
- Do not leave the appliance unattended when it is on.
- Do not cover the ventilation grills. Heat can cause inflammable products to ignite.
- Avoid flux coming into contact with skin or eyes to prevent irritation.
- Be careful with the fumes produced when soldering.
- Keep your workplace clean and tidy. Wear appropriate protection glasses and gloves when working to avoid personal harm.
- Utmost care must be taken with liquid tin waste which can cause burns.
- This appliance can be used by children over the age of eight and also people with reduced physical, sensory or mental capabilities or lack of experience provided that they have been given adequate supervision or instruction concerning the use of the appliance and understand the hazards involved. Children must not play with the appliance.
- Maintenance must not be carried out by children unless supervised.

Specifications

MVE

Pneumatic Desoldering Module for DDE and DME

Ref.: MVE-A

- Net Weight:	700 g / 1.54 lb
- Module Dimensions:	225 x 145 x 55 mm / 8.86 x 5.71 x 2.17 in
- Air Pressure Supply Range:	4 - 6 Bar
- Vacuum at 6 Bar:	90% / 680 mmHg / 26.8 inHg
- Flow Rate:	15 SLPM
- Ambient Operating Temperature:	10 - 40 °C / 50 - 104 °F
- Pedal Connection	
- Total Package Dimension / Weight: (L x W x H)	280 x 195 x 115 mm / 1000 g 11.02 x 7.68 x 4.53 in / 2.20 lb

Complies with CE standards.

ESD safe.

JBC

Warranty

JBC's 2 year warranty covers this equipment against all manufacturing defects, including the replacement of defective parts and labor.

Warranty does not cover product wear or misuse.

In order for the warranty to be valid, equipment must be returned, postage paid, to the dealer where it was purchased.

Get 1 extra year JBC warranty by registering here:
<https://www.jbctools.com/productregistration/>
within 30 days of purchase.

If you register, you will receive e-mail notifications about new software updates for your registered product.



This product should not be thrown in the garbage.

In accordance with the European directive 2012/19/EU, electronic equipment at the end of its life must be collected and returned to an authorized recycling facility.

**CE EAC UK
CA**

www.jbctools.com

0027991-211025