

JBC

www.jbctools.com

Product
website



INSTRUCTION MANUAL



FAE070

Flexible Arm with Clamp

This manual corresponds to the following reference:

FAE070

- Total length (compressed): 0.92 m / 36.22 in
- Max. operating distance: 0.70 m / 27.56 in (see page 4)

Packing List

The following items are included:



Round Metal Nozzle
for FAE



Flexible Arm 1 unit

Already assembled:

Ref. **FAE083** Round Metal Nozzle for FAE

Clamps 2 units



Screws* 2 units
DIN-965 M4x20 - black

Washers* 2 units
DIN-9021 ø4.3 mm - black

Manual 1 unit
Ref. 0019184

* As an alternative to the clamp, the screws and washers can be used to fix the flexible arm to the workbench.

Assembly Example

F AE 070

Flexible Arm with
Clamp - \varnothing 50 mm

Keep in mind the
installation dimensions
(see page 4).

Clamp for mounting the
flexible arm. The clamp
is suitable for a table
thickness of approx.
60 mm or less.

F AE010*

Flexible Hose \varnothing 50 mm
Total length: ~1.6 m / ~63 in

Connect the hose to the
flexible arm.

* The flexible arm can also be fixed
onto the edge of the workbench with
the supplied screws and washers
(image below), or by drilling a hole
and embedding the hose fitting
directly into the workbench (see
page 6).

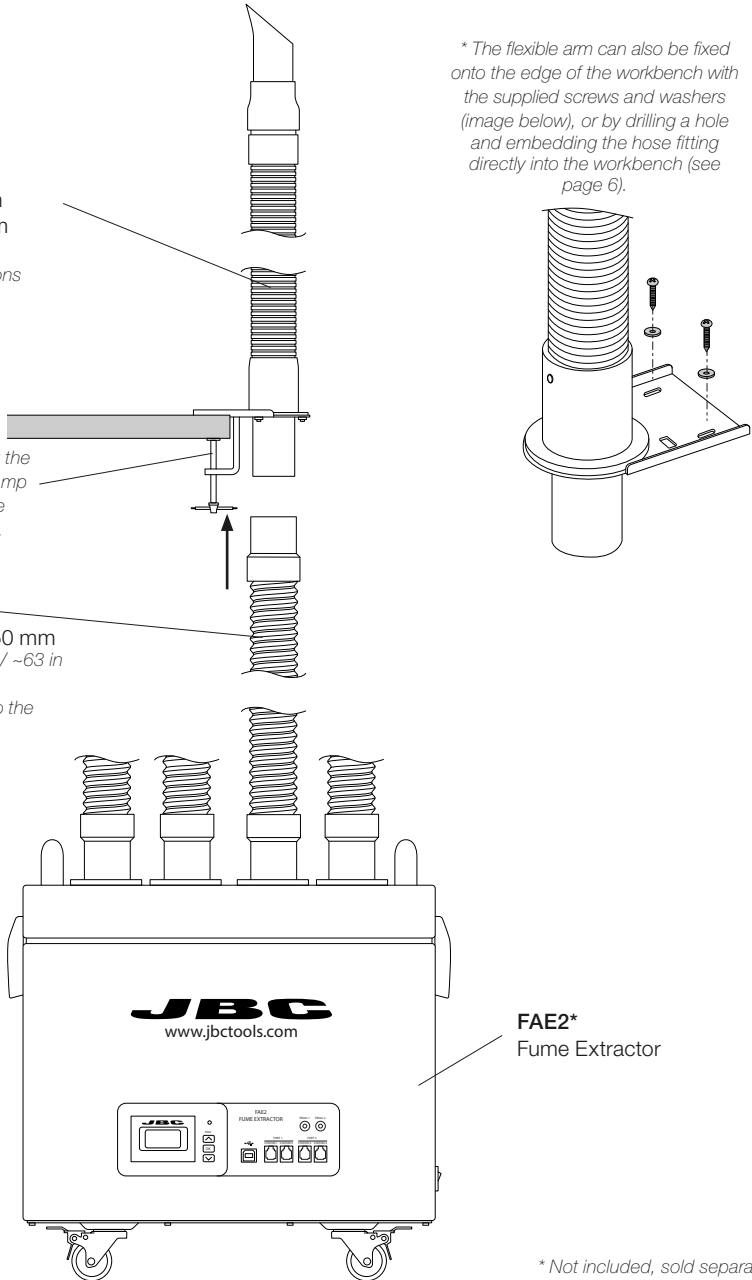

F AE2*
Fume Extractor

* Not included, sold separately.

How to Use

Arm Installation

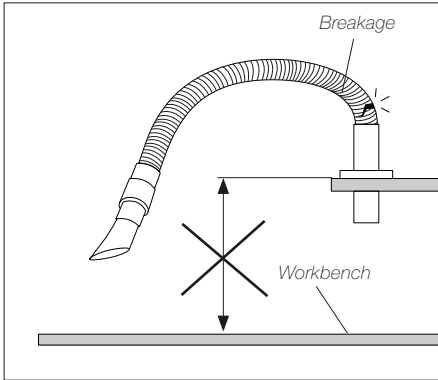

Do not install the flexible arm on shelves or levels higher than the workbench. Forced bending radii can cause the arm to break.

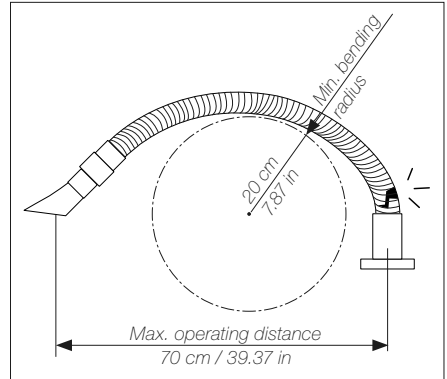

To avoid breaking the hose, do not extend it more than 70 cm / 27.6 in from the center of its base and do not go below the minimum bend radius of 20 cm / 7.87 in.

Arm Positioning

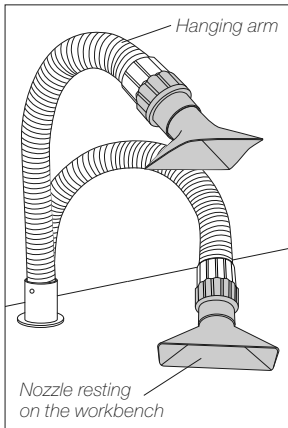

The arm can be used in an upright position with the nozzle hanging over the workplace or with the nozzle resting on the workbench.

Hose Compression

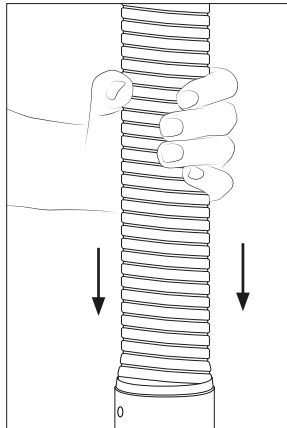

In case of breakage, the hose can be reconnected.

To reconnect the hose, align the two parts and push them firmly until they interlock.

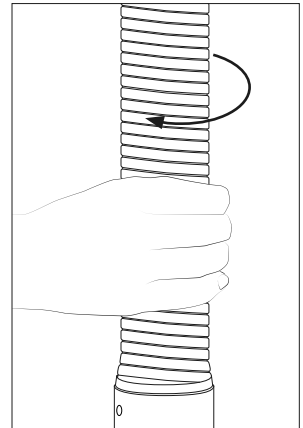

If the hose loses firmness, it must be recompressed.

To increase compression, turn the hose slightly clockwise. After the hose is compressed, readjust its position.

Nozzle Replacement

The nozzle is attached to the hose by means of a bayonet lock, which makes it easy to replace the nozzles.

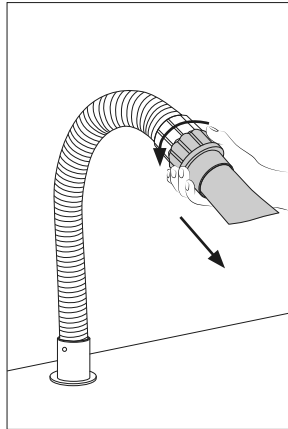

To disassemble the nozzle, hold the hose fitting with one hand. With the other hand, turn the nozzle counter-clockwise and pull it out.

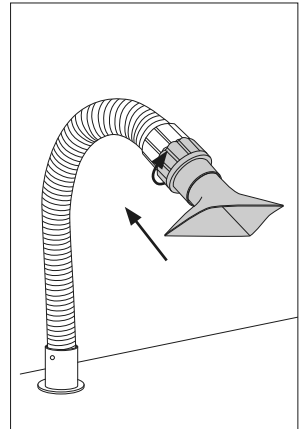

To install a new nozzle, turn the nozzle bayonet clockwise to lock it in place.

Accessories

The supplied nozzle can be replaced by one of the following nozzles. Choose the one that best suits your needs.

Note: FAE070 is **only compatible** with nozzles FAE080, FAE081, FAE082 and FAE083. It is **not compatible** with nozzles FAE090, FAE091, FAE092 and FAE093.



FAE080
Rectangular Nozzle for FAE
approx. 170 x 90 mm /
6.69 x 3.54 in

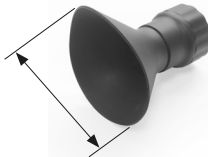

FAE081
Round Nozzle for FAE
approx. \varnothing 120 mm /
 \varnothing 4.72 in

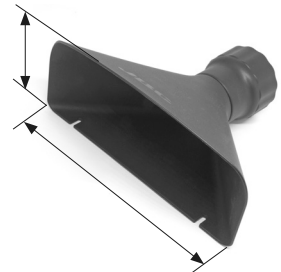

FAE082
Large Rectangular Nozzle for FAE
approx. 227 x 107 mm /
8.94 x 4.21 in

Dimensions Scheme for FAE070 Fixing

To fix the flexible arm FAE070 ($\varnothing 50$) through the workbench, without using the c-clamps, follow these instructions:

- Make the large central hole in your workbench as shown in the drawing below.
- Remove the screws on the flexible arm flange and the fixing tab. Introduce the fitting of FAE070 into the hole and mark the points for the three pilot holes.
- Take out the fitting and drill the three holes at the marked spots. The hole diameter can be found in the dimension scheme:

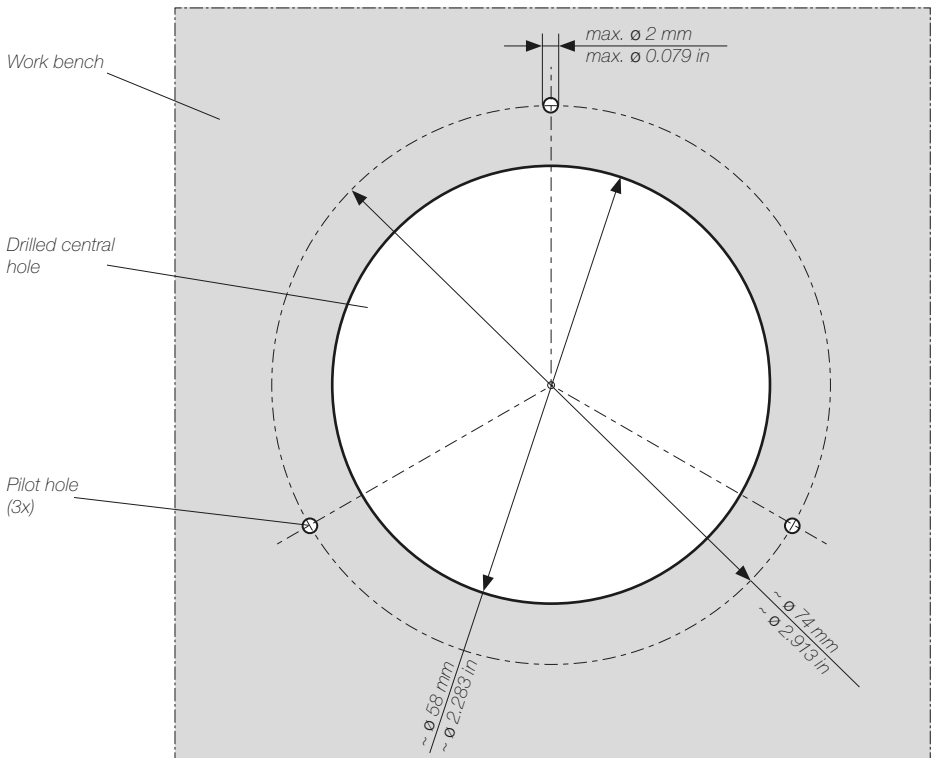

- Return the fitting to the center hole and align the holes in the hose flange with the pilot holes drilled in the workbench. Screw the arm to the bench using the three screws supplied with the arm (assembled on the flange).

Clamp Dimensions

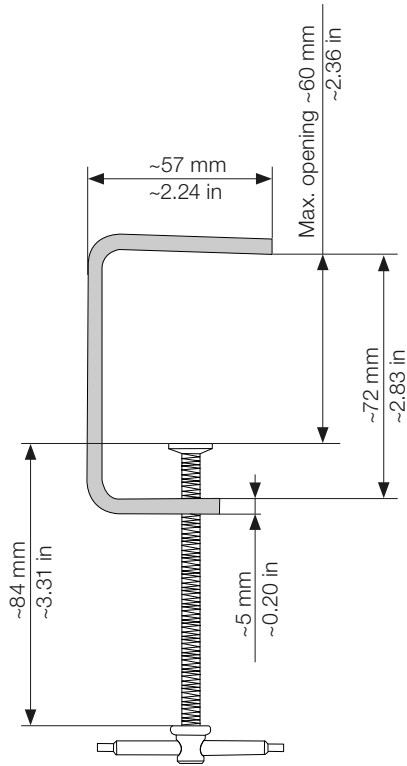

Specifications

F AE070

Flexible Arm with Clamp

Ref. FAE070

- Inner diameter: \varnothing 50 mm / 1.97 in
- Total length (compressed): 0.92 m / 36.22 in
- Max. operating distance: 0.70 m / 27.56 in (see page 4)
- Fixing clamp: For a table thickness of approx. 60 mm or less

- Net weight: 2.2 kg / 4.89 lb
- Total package dimensions / weight:
(L x W x H) 1050 x 170 x 120 mm / 3.0 kg
41.34 x 6.69 x 4.72 in / 6.61 lb

Complies with CE standards.
ESD safe.

JBC

Warranty

JBC's 2 year warranty covers this equipment against all manufacturing defects, including the replacement of defective parts and labor.

Warranty does not cover product wear or misuse.

In order for the warranty to be valid, equipment must be returned, postage paid, to the dealer where it was purchased.



This product should not be thrown in the garbage.

In accordance with the European directive 2012/19/EU, electronic equipment at the end of its life must be collected and returned to an authorized recycling facility.



www.jbctools.com